

GENERAL FITTING GUIDE

for CONCEALED ANTI-VANDAL FIXED HEAD

Maximum Working Pressure	10 Bar
Minimum Working Pressure	0.2 Bar
Maximum Temperature	65 Degrees

Connections	15mm
Thread length	47mm
Outlet Spray	Grid

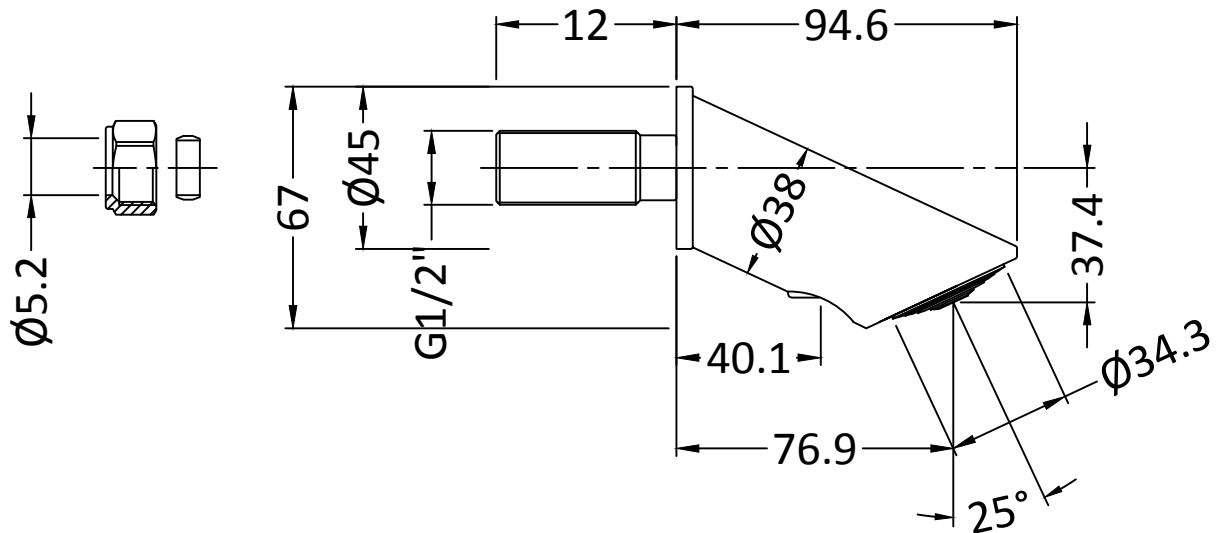

LOCATION

Please ensure the wall surface that these are being mounted to are suitable to secure the shower head, and that they are mounted on a tiled wall or similar waterproof surface, never tile up to the shower head.

INSTALLATION

Please ensure the pipework is flushed through before final commissioning. Debris in the shower may cause it to malfunction.

CONCEALED INSTALLATION

The shower head is always supplied in the configuration for concealed pipework.

Drill a hole through the wall 24mm in diameter.

The shower head can be mounted to the wall using a back nut (not provided) or screws provided as the exposed installation.

Secure to the wall using a back nut, do not over tighten.

Connect the copper supply pipe to the pipe connector using the olive and compression nut, tighten to make a water-tight joint.

Straight or angled swivel connector with fibre washer (tap connector) can also be used.

EXPOSED INSTALLATION

For exposed pipework the configuration of the shower needs to be changed.

Care needs to be taken not to damage the chrome finish during the modification.

Separate the body from the backing plate by un-screwing the grub screw using a 4mm allen key and pulling pulling the bracket away from the shower head.

Un-screw the threaded pipe connector, using a 10mm allen key on the internal hex.

Un-screw the blanking plug from the shower head again using a 10mm allen key, then screw the blanking plug into the backing plate and tighten to make a water-tight joint.

Using the back plate as a template, mark the position for the three fixing holes.

Drill and insert the rawl plugs provided. If the wall is plasterboard or soft building block then additional support or fixings may be required.

Position the backplate on the wall and secure in position using the screws provided.

Push the body onto the backplate taking care not to damage the 'O' ring seal and re-tighten the grub screw using the 4mm allen key, to hold in position.

Connect the supply using the compression nut and olive provided.